

# STACKING DIAGRAMS & FLOOR PLANS

EFFICIENT  
FLOOR PLATES  
& STACKING  
PLAN

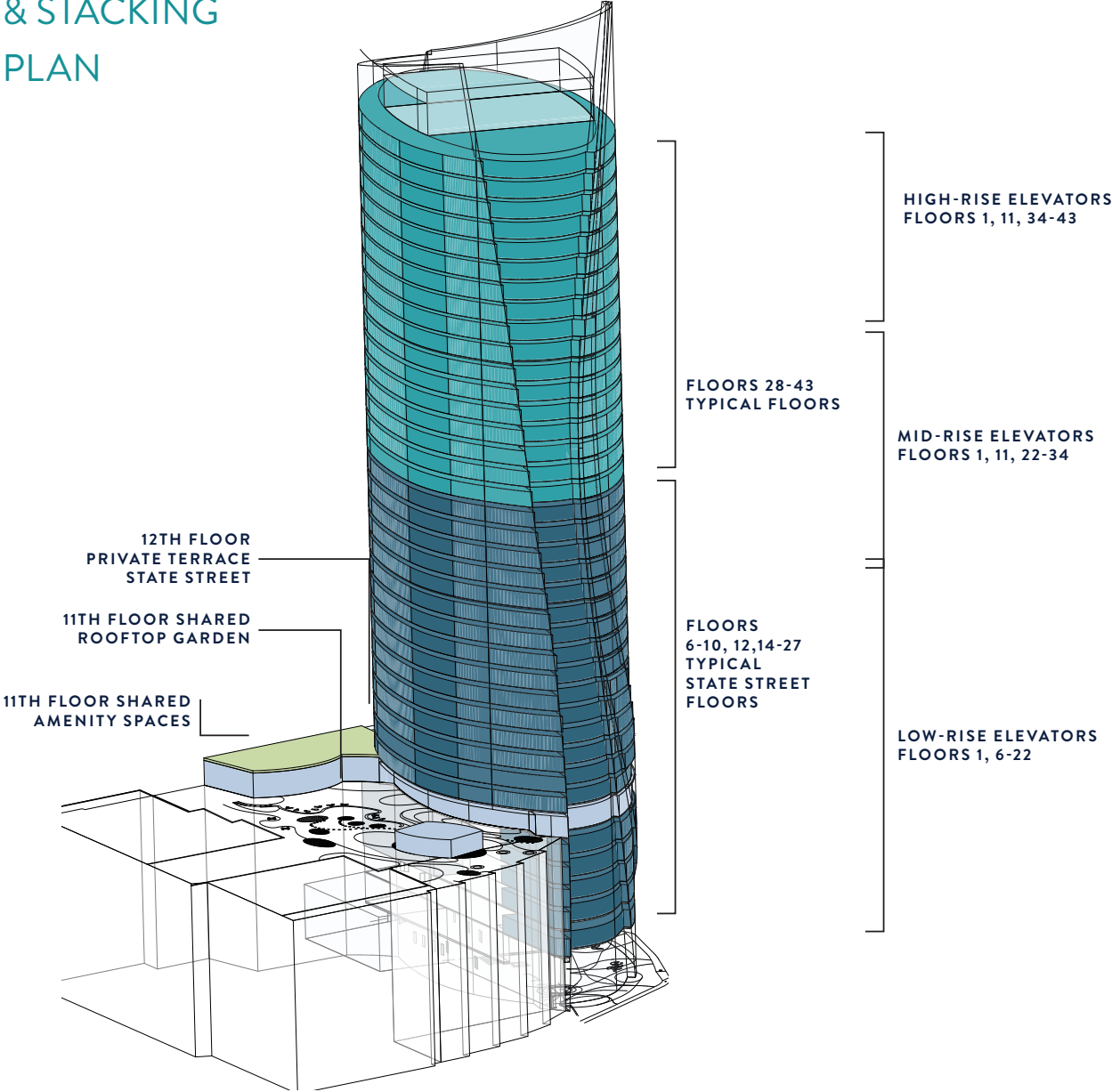



# MID-RISE PERIMETER FLOOR PLAN SAMPLE

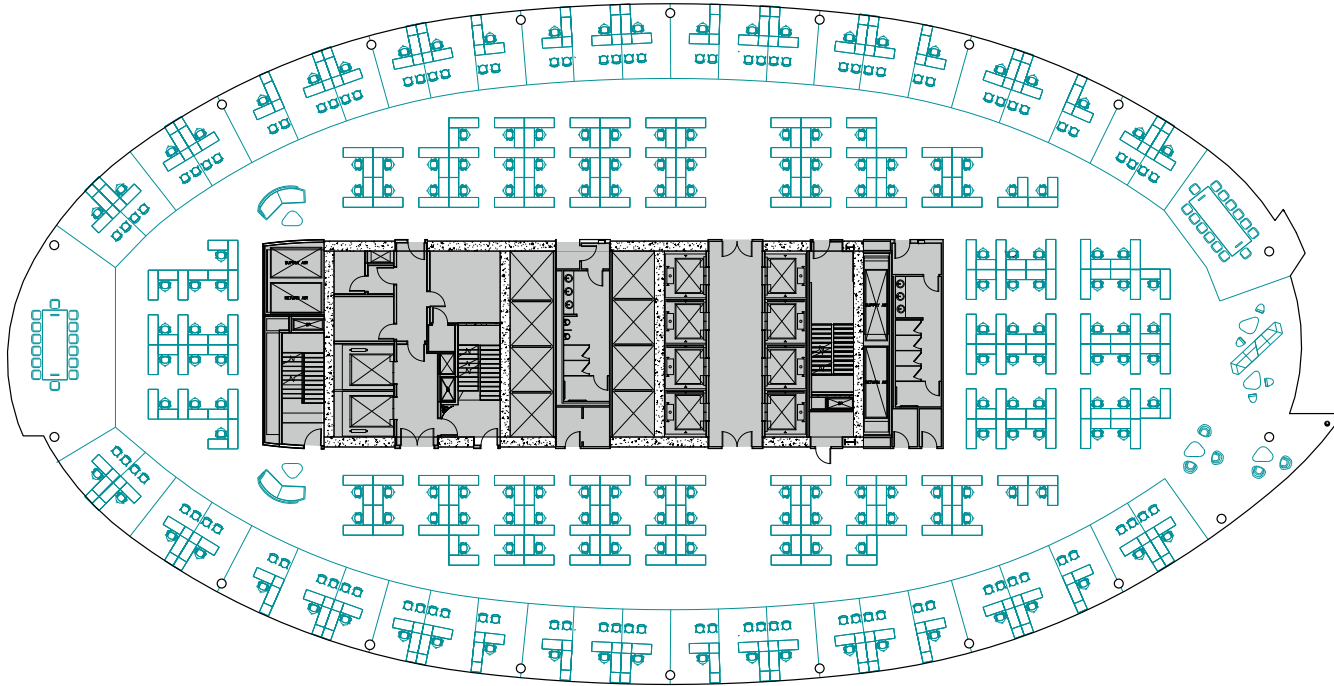

## SF PER PERSON

131 SF/PERSON

## CEILING HEIGHT

9'6"

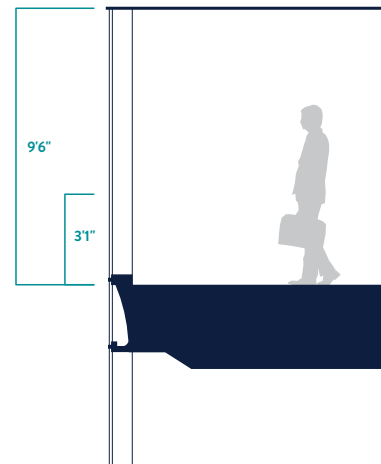

# MID-RISE EFFICIENT FLOOR PLAN SAMPLE

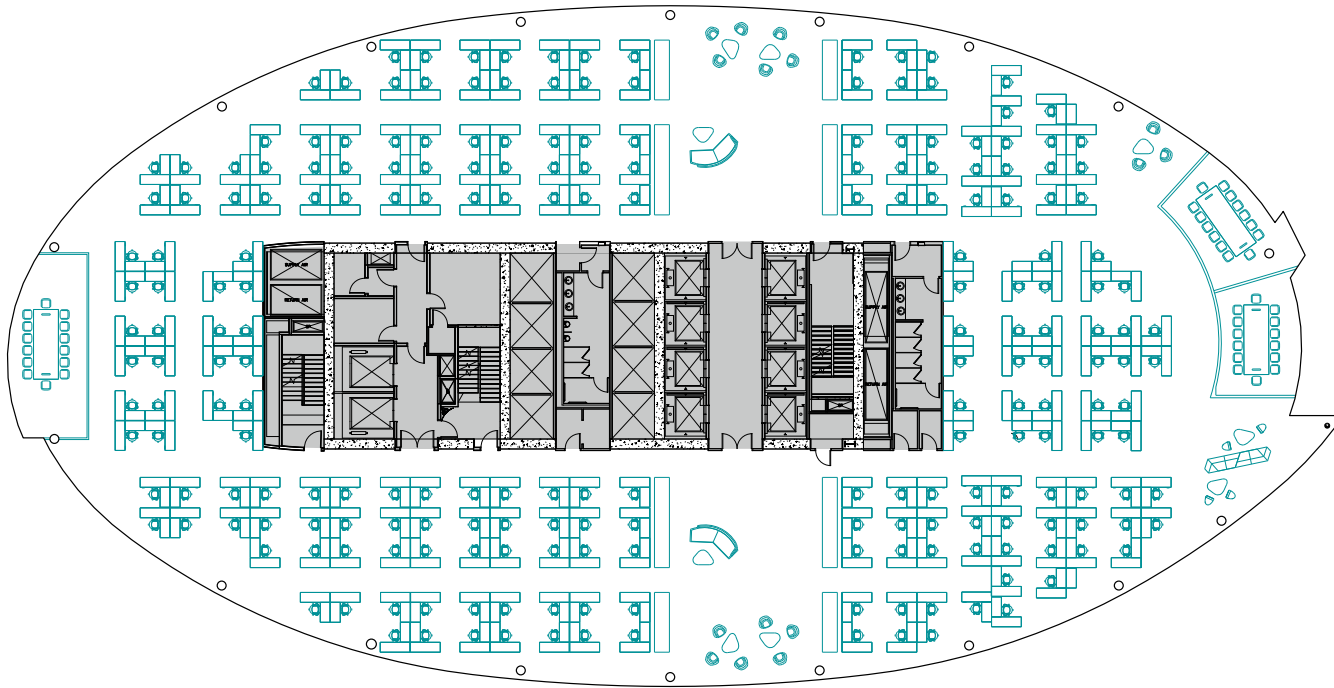

## SF PER PERSON

110 SF/PERSON

## CEILING HEIGHT

9'6"

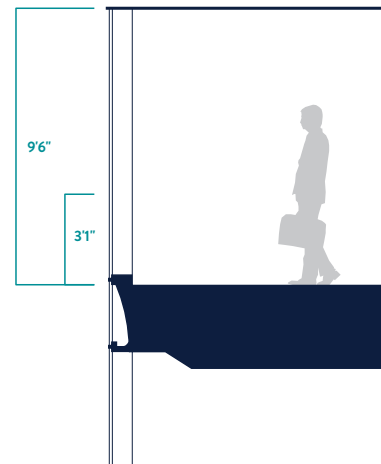



# HIGH-RISE PERIMETER FLOOR PLAN SAMPLE

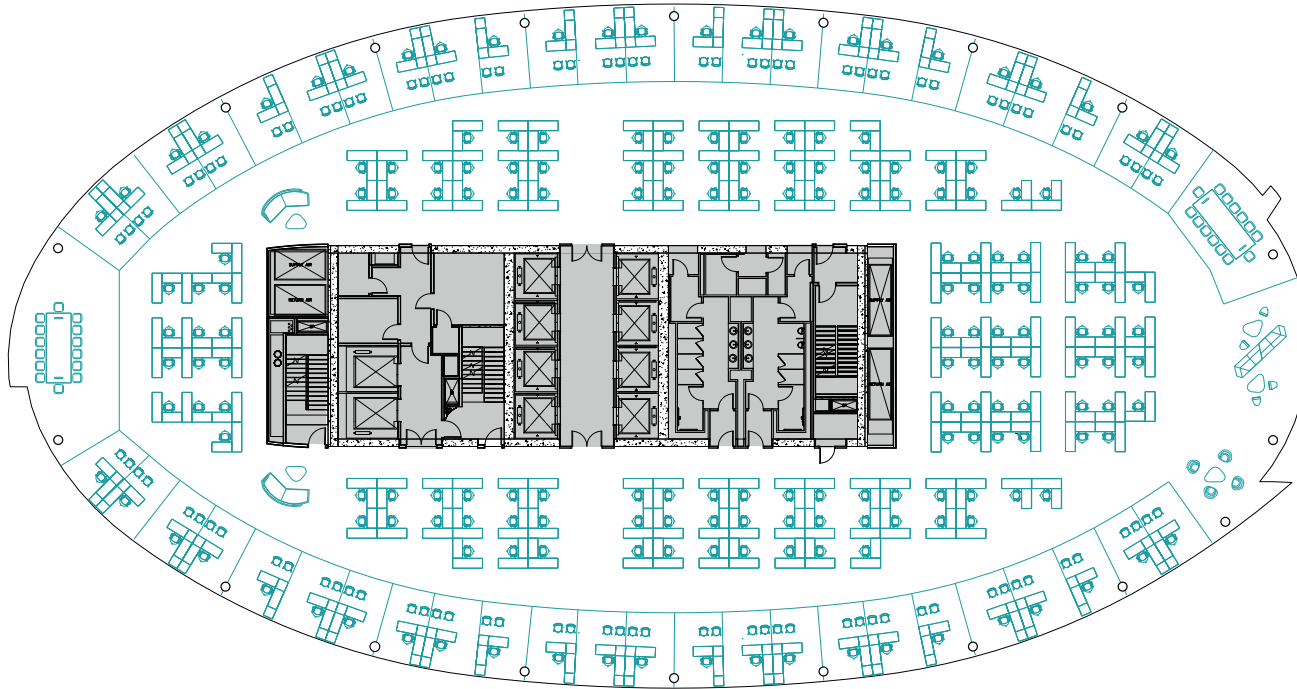

## SF PER PERSON

128 SF/PERSON

## CEILING HEIGHT

9'6"

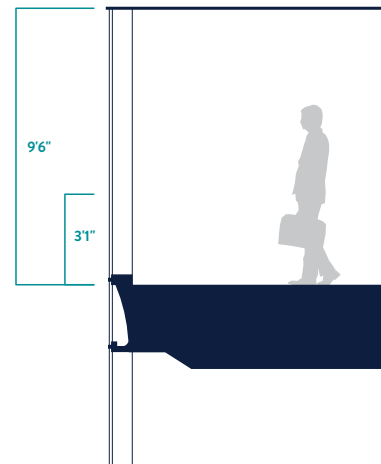

# HIGH-RISE EFFICIENT FLOOR PLAN SAMPLE

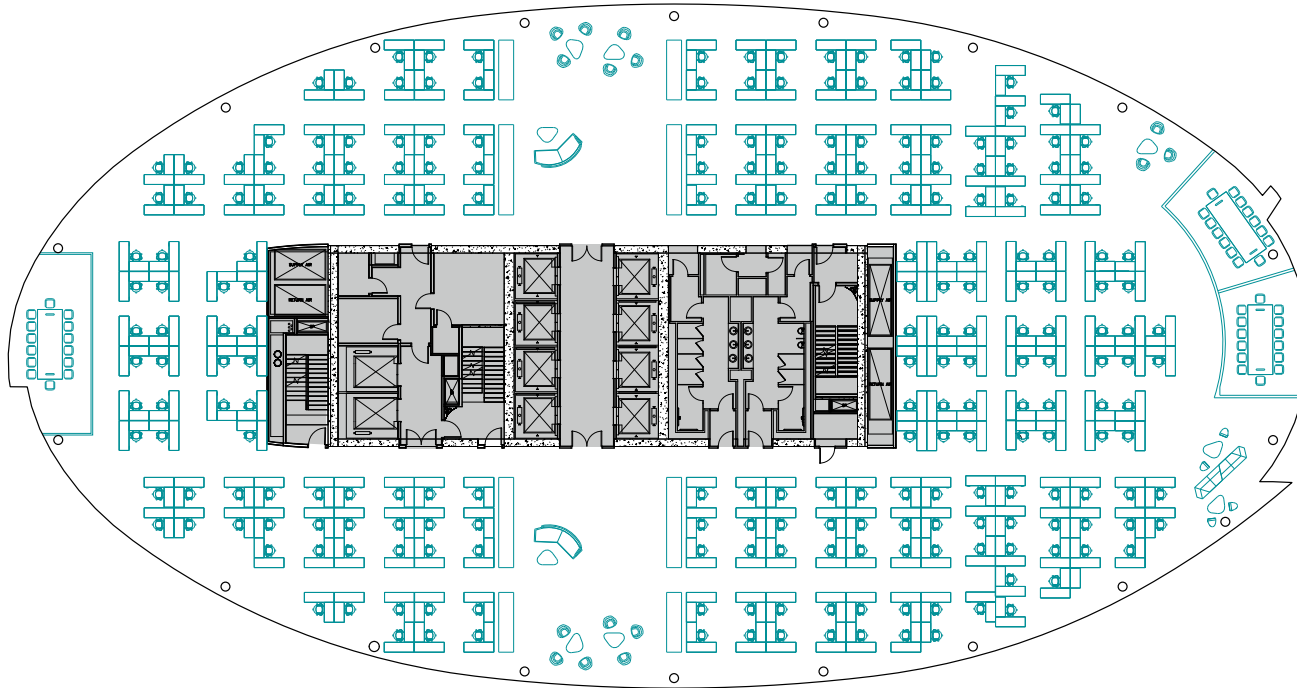

## SF PER PERSON

103 SF/PERSON

## CEILING HEIGHT

9'6"

